

4

3

2

1

THIS DRAWING IS UNPUBLISHED.

RELEASED FOR PUBLICATION

ALL RIGHTS RESERVED.

© COPYRIGHT - By TE Connectivity

LOC  
HB

DIST  
-

REVISIONS

| P | LTR | DESCRIPTION   | DATE          | DWN       | APVD         |
|---|-----|---|---------------|-----------|--------------|
| E |     | 1.UPDATE TE LOGO AND LOGO Z ADD LINE IDENTIFICATION<br>3.TERMINALS TOLERANCE CLARIFICATION 4.VENT HOLE CHANGE | ECO-12-005726 | 06-APR-12 | D.L<br>B.H.Y |

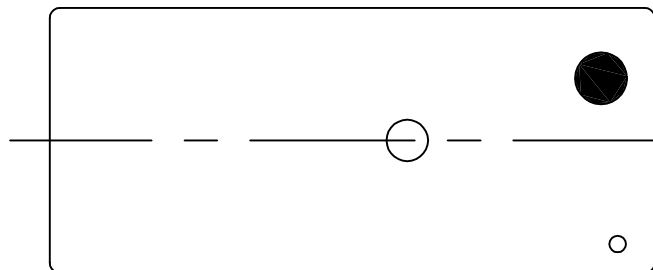

Ⓞ Ⓞ Ⓞ PART A PART B

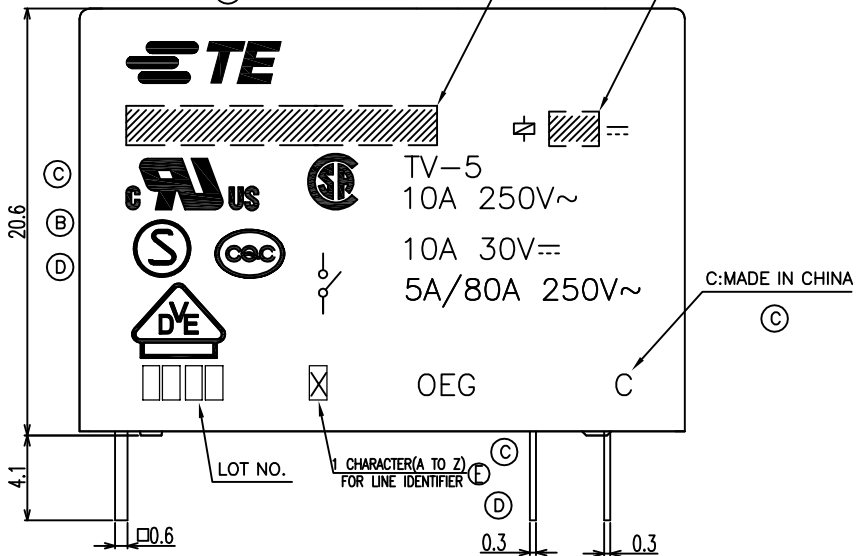

CONNECTION DIAGRAM (BOTTOM VIEW)



DRILLING DIAGRAM(2/1) (BOTTOM VIEW)

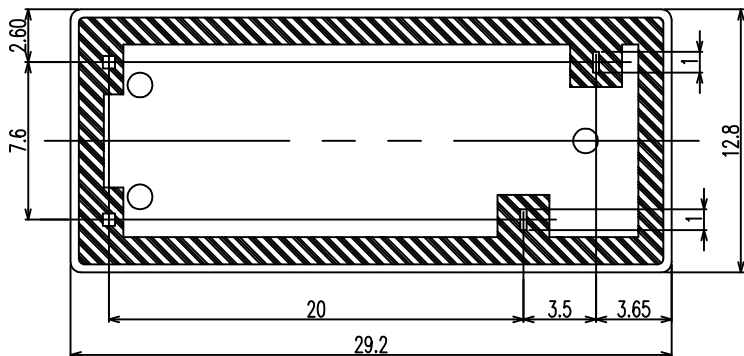
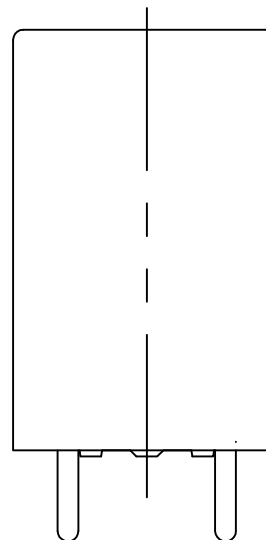
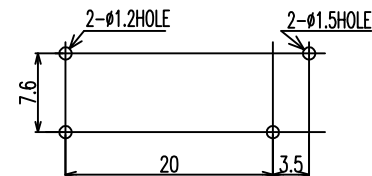

THIS DRAWING IS A CONTROLLED DOCUMENT.

DIMENSIONS:  
mm

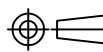

TOLERANCES UNLESS OTHERWISE SPECIFIED:

|        |   |
|--------|---|
| 0 PLC  | ± |
| 1 PLC  | ± |
| 2 PLC  | ± |
| 3 PLC  | ± |
| 4 PLC  | ± |
| ANGLES | ± |

MATERIAL

FINISH

DWN

FU,BO

CHK

ZHANG,XIAONING

APVD

C.H.HSU

PRODUCT SPEC

APPLICATION SPEC

WEIGHT

CUSTOMER DRAWING



TE Connectivity

NAME

OMIT CUSTOMER DRAWING

SIZE CAGE CODE DRAWING NO RESTRICTED TO

A3 00779 C=9-1440000-6

SCALE 4:1 SHEET 1 of 2 REV E

THIS DRAWING IS UNPUBLISHED.

RELEASED FOR PUBLICATION

-. - .

© COPYRIGHT - By TE Connectivity

ALL RIGHTS RESERVED.

| LOC | DIST | REVISIONS |     |             |      |     |      |
|-----|------|-----------|-----|-------------|------|-----|------|
| HB  | -    | P         | LTR | DESCRIPTION | DATE | DWN | APVD |
|     |      | -         |     | SEE SHEET 1 | -    | -   | -    |

NOTES:  
B 1. LOT NO. SYSTEM AS FOLLOING:

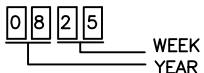

2. GENERAL TOLERANCE AS FOLLOWING:

| TOLERANCE  |      |
|------------|------|
| 0~0.99mm   | ±0.1 |
| 1mm~2.99mm | ±0.2 |
| 3mm MIN.   | ±0.3 |

C 3. TERMINAL DIMENSION IS NOT INCLUDING SOLDER TIP.

E 4. FOR THE TIN-PLATING OF THE PINS:  
+0.1mm FOR WIDTH, THICKNESS AND DIAMETER.  
+0.5mm FOR LENGTH.

|             |               |        |               |
|-------------|---------------|--------|---------------|
| 2-1461387-3 | OMIT-SH-148LM | 48V    | OMIT-SH-148LM |
| 2-1461387-1 | OMIT-SH-148DM | 48V    | OMIT-SH-148DM |
| 1-1461387-9 | OMIT-SH-124LM | 24V    | OMIT-SH-124LM |
| 1-1461387-7 | OMIT-SH-124DM | 24V    | OMIT-SH-124DM |
| 9-1440000-6 | OMIT-SH-112LM | 12V    | OMIT-SH-112LM |
| 1-1461387-4 | OMIT-SH-112DM | 12V    | OMIT-SH-112DM |
| 1-1461387-2 | OMIT-SH-109LM | 9V     | OMIT-SH-109LM |
| 1-1461387-0 | OMIT-SH-109DM | 9V     | OMIT-SH-109DM |
| 1461387-8   | OMIT-SH-106LM | 6V     | OMIT-SH-106LM |
| 1461387-6   | OMIT-SH-106DM | 6V     | OMIT-SH-106DM |
| 1461387-4   | OMIT-SH-105LM | 5V     | OMIT-SH-105LM |
| 1461387-2   | OMIT-SH-105DM | 5V     | OMIT-SH-105DM |
| TE PART NO  | DESCRIPTION   | PART B | PART A        |

RELAY TYPE

|                  |            |             |                     |      |
|------------------|------------|-------------|---------------------|------|
|                  |            | UV RESIN    | UV SEAL             | 16   |
|                  |            | EPOXY RESIN | SEAL                | 15   |
| UL94 V-0         |            | PBT         | CASE                | 14   |
| CLASS E          |            | UEW         | MAGNETIC WIRE       | 13   |
| UL94 V-0         |            | PET         | BASE                | 12   |
| UL94 V-0         |            | PBT         | BOBBIN              | 11   |
|                  | SOLDER DIP | CP WIRE     | COIL TERMINAL       | 10   |
| UL94 V-0         |            | PPS         | CARD                | 9    |
|                  |            | Ag ALLOY    | MOVABLE CONTACT     | 8    |
|                  |            | Ag ALLOY    | STATIONARY CONTACT  | 7    |
|                  |            | Cu ALLOY    | HINGE SPRING        | 6    |
|                  | SOLDER DIP | Cu ALLOY    | STATIONARY TERMINAL | 5    |
|                  | SOLDER DIP | Cu ALLOY    | MOVABLE SPRING      | 4    |
|                  |            | STEEL       | CORE                | 3    |
|                  |            | STEEL       | ARMATURE            | 2    |
|                  |            | STEEL       | YOKE                | 1    |
| INCOMBUSTIBILITY | TREATMENT  | MATERIAL    | DESCRIPTION         | ITEM |

|  |            |                        |   |  |
|--|------------|------------------------|---|--|
| THIS DRAWING IS A CONTROLLED DOCUMENT. |            | DWN<br>FU,BO           | TE Connectivity<br><b>OMIT CUSTOMER DRAWING</b> |  |
| DIMENSIONS:<br>mm                      |            | CHK<br>ZHANG, XIAONING |   |  |
|  |            | APVD<br>C.H.HSU        | PRODUCT SPEC                                    |  |
| TOLERANCES UNLESS OTHERWISE SPECIFIED: |            | APPLICATION SPEC       | SIZE  |  |
| 0 PLC ± -                              | 1 PLC ± -  | WEIGHT                 | CAGE CODE                                       |  |
| 2 PLC ± -                              | 3 PLC ± -  | DRAWING NO             |   |  |
| 4 PLC ± -                              | ANGLES ± - | RESTRICTED TO          |   |  |
| MATERIAL                               | FINISH     | A3 00779 C=9-1440000-6 |   |  |
| CUSTOMER DRAWING                       |            | SCALE                  | SHEET   |  |
|  |            | 4:1                    | 2 of 2  |  |
|  |            | REV                    | E   |  |