

CI-32139-000

SHT 1.1

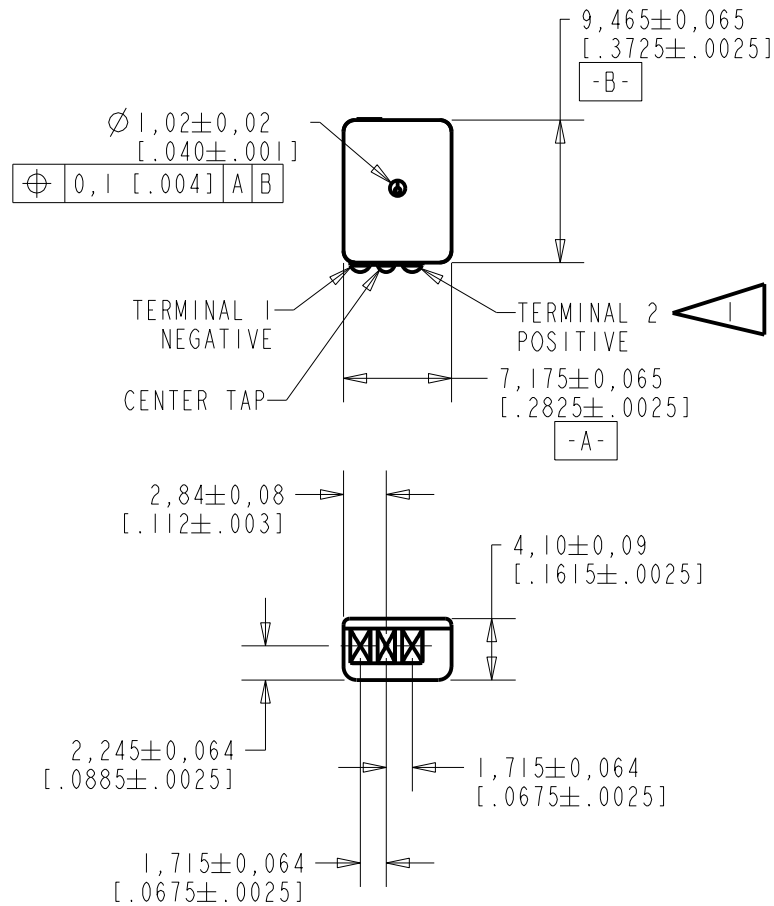

NOTES:

A POSITIVE GOING VOLTAGE AT TERMINAL 2, RELATIVE TO TERMINAL 1, CAUSES AN INCREASE IN PRESSURE AT THE SOUND OUTLET.

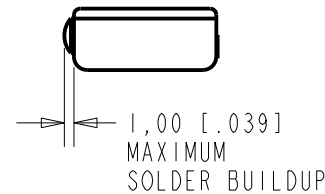

DIMENSIONS IN MILLIMETERS [INCHES]

KNOWLES ELECTRONICS
ITASCA, ILLINOIS U.S.A.

| Revision | C.O. # | Implementation Date | RELEASE LEVEL | REVISION |
|----------------------|-----------|---------------------|---------------|----------|
| | | | Active | A |
| A | CI0115362 | 4-3-14 | | |
| SCALE: 2:1 | | | DR. BY | DATE |
| DO NOT SCALE DRAWING | | | JL | 10-23-13 |
| TITLE: RECEIVER | | | CK. BY | DATE |
| OUTLINE DRAWING | | | GJP | 4-10-14 |
| | | | APP. BY | DATE |
| | | | GJP | 4-10-14 |
| | | | CI-32139-000 | |
| | | | SHT 1.1 | |

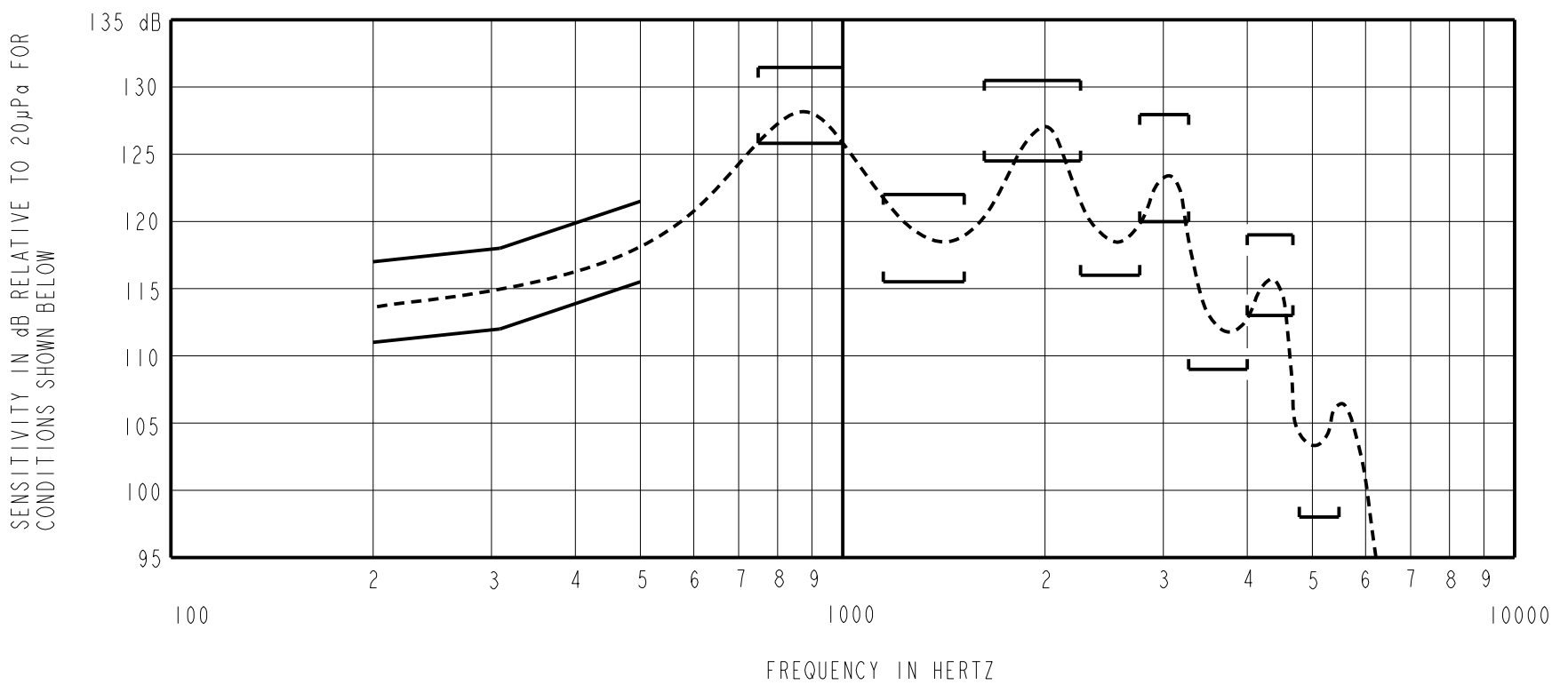

NOTES:

1. MEASUREMENTS MADE USING 8mm (.315") X 1mm (.039") ID + 28mm (1.10") X 1.5mm (.059") ID EAR HOOK SIMULATOR INTO 25mm (.984") OF 2 mm (.079") ID TUBE + 18mm (.709") OF 3mm (.118") ID TUBE + 2 cm³ CAVITY ANSI S3.6 TYPE HA-3 (IEC 60318-5).

2. SENSITIVITY

| FREQUENCY | MIN. | MAX. |
|-----------|-------|-------|
| 200 | 111.0 | 117.0 |
| 300 | 112.0 | 118.0 |
| 500 | 115.5 | 121.5 |
| 750-1000 | 125.5 | 131.5 |
| 1200-1600 | 116.0 | 122.0 |
| 1700-2300 | 124.5 | 130.5 |
| 2300-2800 | 116.0 | --- |
| 2800-3300 | 120.0 | 128.0 |
| 3300-4000 | 109.0 | --- |
| 4000-4700 | 113.0 | 119.0 |
| 4800-5500 | 98.0 | --- |

3. RESPONSE, IMPEDANCE, AND DISTORTION MEASUREMENTS MADE USING THE ELECTRICAL TEST CONDITIONS SHOWN BELOW.

4. INDIVIDUAL SPECIFICATIONS.

| PORT LOCATION | ELECTRICAL TEST CONDITIONS | | | | IMPEDANCE @ 500Hz OHMS±15% | DCR @20°C OHMS ±10% | DISTORTION | |
|---------------|----------------------------|-------|------------|-------|----------------------------|---------------------|------------|----------|
| | RESPONSE & IMPEDANCE | | DISTORTION | | | | MAX. % | FREQ. Hz |
| | AC mA RMS | DC mA | AC mA RMS | DC mA | | | | |
| 0JN | 3.75 | 0.0 | 7.5 | 0.0 | 47 | 20 | 10 | 500 |

5. ELECTRICAL SOURCE IMPEDANCE MUST BE GREATER THAN 20 TIMES STATED IMPEDANCE FOR TEST CONDITIONS ABOVE.

| Revision | C.O. # | Implementation Date | RELEASE LEVEL | REVISION |
|----------|-----------|---------------------|---------------|----------|
| A | CI0115362 | 4-3-14 | Active | A |

| | | | |
|--|--|---------|----------|
| WHEN TEST LIMITS ARE USED TO ESTABLISH INCOMING INSPECTION ACCEPTANCE/REJECTION CRITERIA, CORRELATION OF TEST EQUIPMENT WITH KNOWLES IS ALSO REQUIRED FOR ELIMINATION OF EQUIPMENT AND TEST METHOD VARIATION | | DR. BY | DATE |
| TITLE: RECEIVER | | JL | 10-23-13 |
| | | CK. BY | DATE |
| PERFORMANCE SPECIFICATION | | GJP | 4-10-14 |
| | | APP. BY | DATE |
| | | GJP | 4-10-14 |

KNOWLES ELECTRONICS
ITASCA, ILLINOIS U.S.A.

CI-32139-000
SHT 2.1